

No. 2

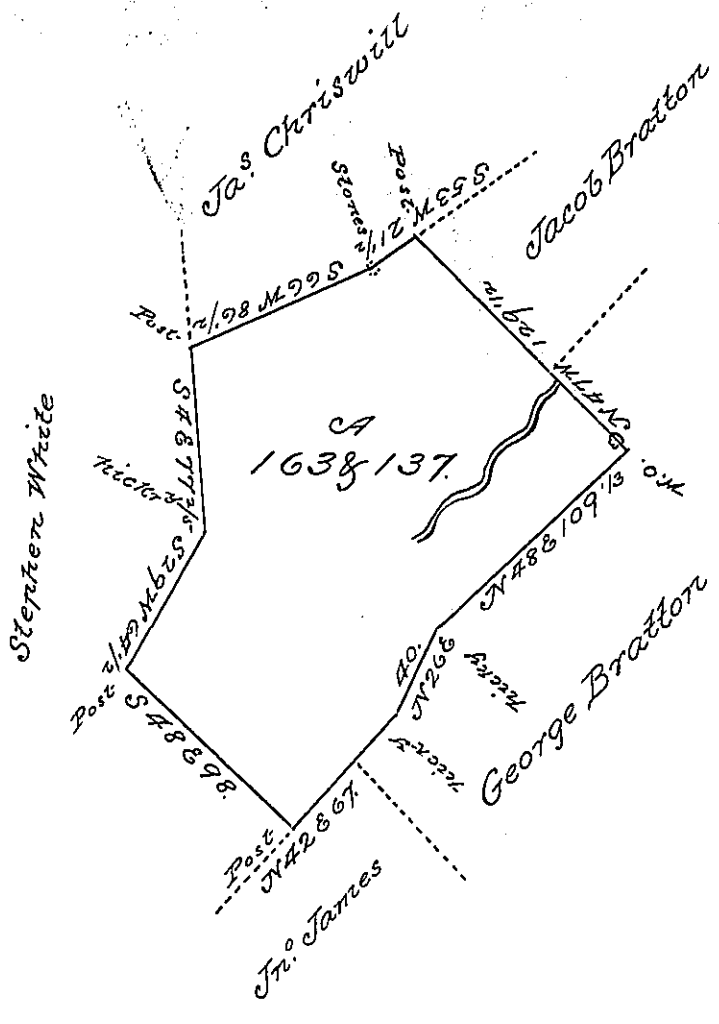

A Draft of one hundred and sixty three acres and one hundred and thirty seven perches of Land with six per Cent for Roads situate in Wayne Township in Mcifflin, Late Cumberland County, which appears to have been surveyed 25th April 1787 in pursuance of a Warrant to Edward Bratton dated 14th June 1786 & resurveyed in part, examined and corrected 11th February 1814

The original survey was said to contain 157 1/2 acres
 Michael M. Monahan

To Richard T. Leech Esquire }
 Surveyor General of Pennsylvania }

IN TESTIMONY that the above is a copy of the original remaining on file in the Department of Internal Affairs of Pennsylvania, made conformably to an Act of Assembly approved the 16th day of February, 1833, I have hereunto set my Hand and caused the Seal of said Department to be affixed at Harrisburg, this

Sixth day of July 1897

James W. Latta
 Secretary of Internal Affairs.